



Thanks for visiting <http://houseplans.co> - the home of The Mascord Collection of house plans. Please let us know if we can aid in your search for your home design.



Stylish Single Story with Great Outdoor Space

Plan 1248
The Ripley

Heated Area:
Main Floor: 2233 Sq.Ft.

Sub-Total: 2233 Sq.Ft.
Bonus: +426 Sq.Ft.

Dimensions:

265'9"

Main Floor Plan

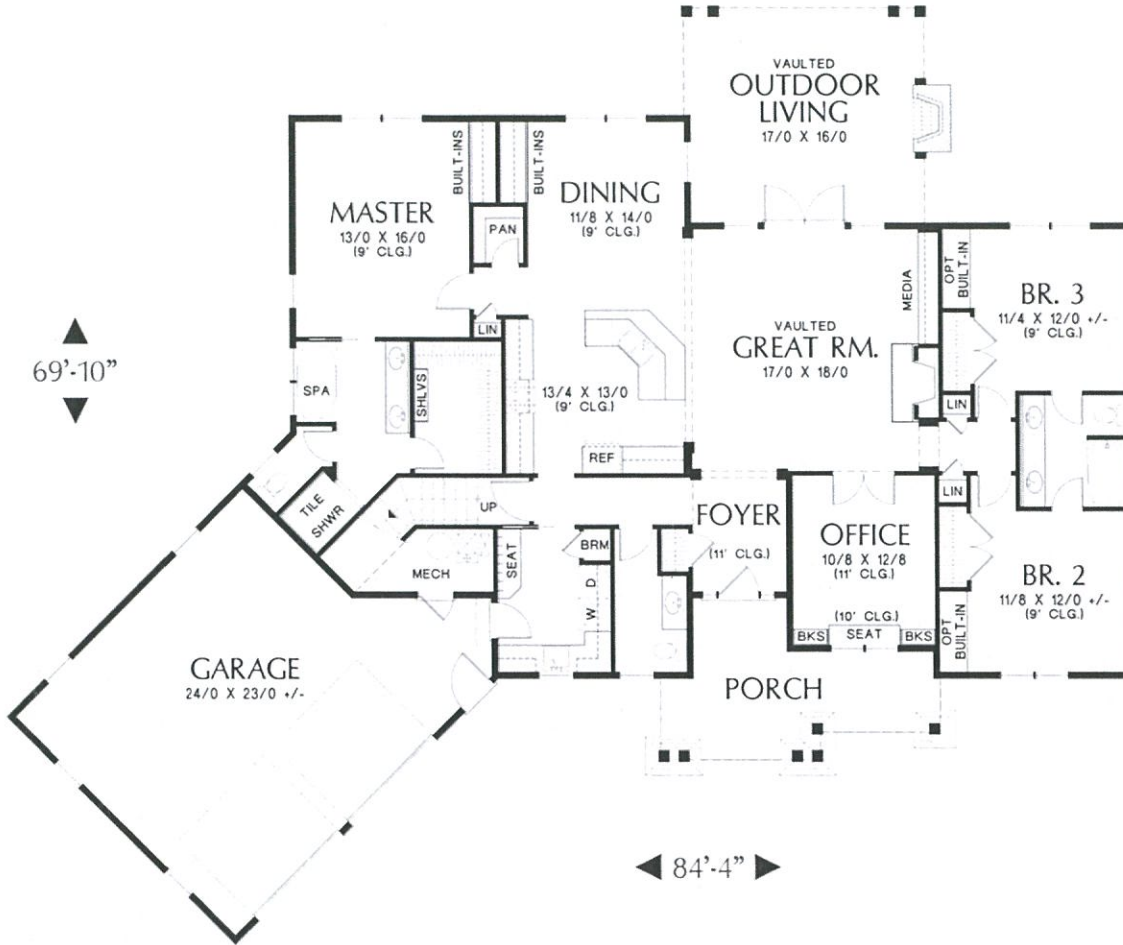

Width: 84'-4"
 Depth: 69'-10"
 Height (Midpt): 20'-6"
 Height (Peak): 31'-0"

Amenities:
 Bedrooms: 3
 Full Baths: 2
 Half Baths: 1
 Garage Bays: 2 Car Garage
 Garage Area: +639 Sq.Ft.
 Stories (above grade): 1

Plan Features:
 Bonus Room
 Covered Patio
 Den
 Jack & Jill Bathroom
 Mud Room
 Office
 Outdoor Living Room
 Split Bedrooms
 Walk-In Pantry

Structure:
 Walls: 6" Wood Frame
 Roof: Truss Roof
 Snowload: 25# psf

Foundations Available:
 Joisted Post & Beam @ 32" O/C
 (In-Ground Basement)

[View In-Ground Basement Version](#)

Available Packages:

Bidding Pkg: \$750.00
 Printed 5x: \$1150.00
 Digital PDF & Printed 5x: \$1200.00
 Digital PDF: \$1100.00
 CAD Files: \$2200.00



This home design is Copyrighted by Alan Mascord Design Associates Inc

[More Info / Order](#)

To order by phone call our customer service team:

(800) 411 0231

[Email Us](#)

[Cost to Build Estimate](#)

[Find a Contractor](#)

[Find a Realtor](#)

Upper Floor Plan

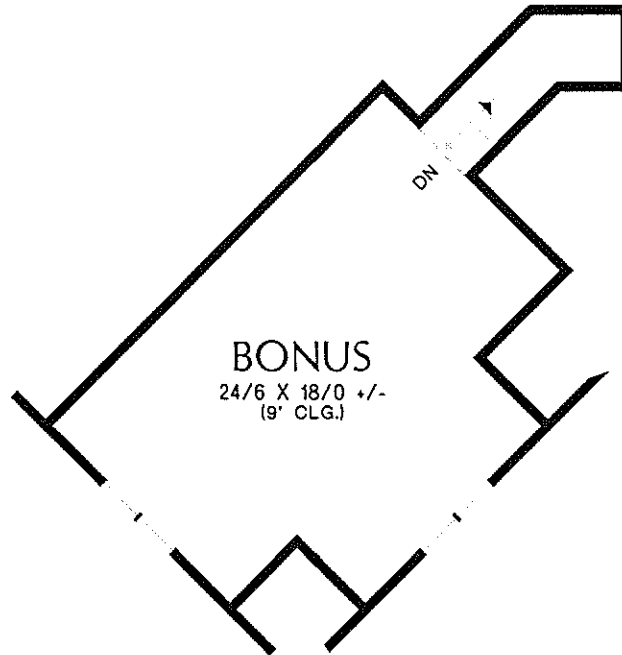

This home design is Copyrighted by Alan Mascord Design Associates Inc



Pin image

The Ripley

With a two-car garage angling off to the left, the Ripley's curved façade seems to embrace the visitor. A door next to the garage acts as an informal entrance; under a covered porch with two beautiful gables sits the front door. Entering here, you find yourself in a lovely foyer with eleven-foot ceilings. Walking forward, you enter the vaulted great room, which flows out, through a set of double doors, to the vaulted outdoor living room. A vision enters your mind of a late summer shindig, friends gathering around cozy fires crackling in the fireplaces here, fending off the first hints of winter's chill. Both the great room and the outdoor living room boast a fireplace. The great room also has a built-in media center.

The rest of the home radiates off this stunning shared living space. Walking in a clockwise pattern from the foyer, the main floor includes an office with a window seat looking over the front porch, two bedrooms with a Jack-and-Jill bathroom in-between, the outdoor living room, the open dining room and kitchen, and in the back corner, the master bedroom. Wandering back to the entry foyer, you see a hall off to the left; this contains a half bath, the utility room with its washer and dryer, stairs to the upper story, and a door to the garage.

Architectural Styles Associated with this design

Craftsman